

JUMO GmbH & Co. KG
Delivery address: Mackenrodtstraße 14,
36039 Fulda, Germany
Postal address: 36035 Fulda, Germany
Phone: +49 661 6003-0
Fax: +49 661 6003-607
E-mail: mail@jumo.net
Internet: www.jumo.net

JUMO Instrument Co. Ltd.
JUMO House
Temple Bank, Riverway
Harlow, Essex CM20 2DY, UK
Phone: +44 1279 635533
Fax: +44 1279 635262
E-mail: sales@jumo.co.uk
Internet: www.jumo.co.uk

JUMO Process Control, Inc.
8 Technology Boulevard
Canastota, NY 13032, USA
Phone: 315-697-5866
1-800-554-JUMO
Fax: 315-697-5867
E-mail: info@jumo.us
Internet: www.jumo.us



JUMO HEATtemp

Push-in RTD temperature probe for heat meter with connection cable for immersion sleeves (type PS/PL)

- For temperatures from 0 to 180 °C
- Approval for heat meter MID and domestic approval as exchangeable temperature probes
- Meets the requirements as per DIN EN 1434, AGFW FW202 and FW211
- Approval for cold meter and cold / heat meter combinations
- Paired and calibrated as per the German calibration regulations
- Production certified as per module D of the MID (CE and metrology sign)
- Adapted accessories for installation (data and price sheet 902440)

Heat meter RTD temperature probes are used for temperature measurement in closed-loop pipe systems. Thanks to the installation in thermowells with tolerance on fit for optimum thermal coupling, the system need no longer be discharged at the time of the regular exchange once the certification period has elapsed.

The temperature probes are approved in accordance with the EU directive 2004/22/EC (MID) as well as according to the German calibration regulations (domestic approval). The temperature probes are available paired and calibrated. The state-approved test body for heat KF2 is responsible for this purpose. Moreover, the production is certified according to module D of MID, and the temperature probes are also available with the CE and metrology sign.

Note:

In Germany, temperature probes, type PS, with MID approval may no longer be installed in new installations smaller than DN 25 pipe systems (4th. amendment of the Calibration Regulations).

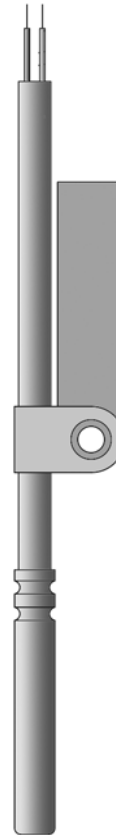

Technical Data

| | |
|--------------------------------|--|
| Process connection | Push-in RTD temperature probe for thermowells (immersion sleeves) |
| Connection | Wire end ferrules |
| Connection cable | PVC, PUR, TPE, Silicone; unshielded or shielded For the max. connection cable lengths, refer to the table on the following page |
| Thermowell | Type PS: stainless steel Ø 5.0 mm, Ø 5.2 mm or Ø 6.0 mm Type PL: stainless steel Ø 6.0 mm Thermowell with tolerance to fit for thermowells |
| Measuring insert | Platinum temperature probe as per DIN EN 60751 Rated value: Pt100, Pt500, Pt1000; class B Connection: 2-wire/4-wire circuit |
| Temperature | Type PS: 0 to 150 °C Type PL: 0 to 180 °C |
| Temperature difference | Type PS: 3 to 150 K Type PL: 3 to 180 K |
| Minimum immersion depth | Type PS: > 15 mm Type PL: 30 mm |
| Fitting length | Type PS: 45 to 85 mm Type PL: 85 to 450 mm |
| Response behavior | Type PS: $t_{0.5} = 15$ s (installed in thermowell) Type PL: $t_{0.5} = 12$ s (installed in thermowell) |
| Ambient conditions | Climatic 0 to 70 °C Protection class IP65 Electromagnetic E1 Mechanical M3 |
| Accessories | For the thermowell, refer to the data and price sheet 902440 |

JUMO GmbH & Co. KG
 Delivery address: Mackenrodtstraße 14,
 36039 Fulda, Germany
 Postal address: 36035 Fulda, Germany
 Phone: +49 661 6003-0
 Fax: +49 661 6003-607
 E-mail: mail@jumo.net
 Internet: www.jumo.net

JUMO Instrument Co. Ltd.
 JUMO House
 Temple Bank, Riverway
 Harlow, Essex CM20 2DY, UK
 Phone: +44 1279 635533
 Fax: +44 1279 635262
 E-mail: sales@jumo.co.uk
 Internet: www.jumo.co.uk

JUMO Process Control, Inc.
 8 Technology Boulevard
 Canastota, NY 13032, USA
 Phone: 315-697-5866
 1-800-554-JUMO
 Fax: 315-697-5867
 E-mail: info@jumo.us
 Internet: www.jumo.us





| Cable cross-section | Max. connection cable length AL for Pt100 | Max. connection cable length AL for Pt500 | Max. connection cable length AL for Pt1000 |
|----------------------|---|---|--|
| 0.22 mm ² | 2500 mm | 12500 mm | 25000 mm |
| 0.34 mm ² | 3500 mm | 17500 mm | 35000 mm |
| 0.50 mm ² | 5000 mm | 25000 mm | 50000 mm |

Note:

Also take into account a possible connection cable length limitation due to the design approval of the arithmetic unit/counter.
 For 4-wire circuit, the max. connection cable lengths are limited due to the requirements of the arithmetic unit/counter.

Approval overview

| Version | Basic type | Approval | |
|--|---|--|---|
| | | Type | Number |
| Figure: PS  | 90.276-F40 (PS) 902435/05 (PS) | Domestic (Germany) | 22.30/89.07 (Pt100) (150 °C) 22.30/89.08 (Pt500) (150 °C) 22.30/89.09 (Pt1000) (150 °C) |
| | 902435/10 (PS) 902435/11 (PS) | Domestic (Germany) | 22.30/99.10 (105 °C) |
| | 902435/50 (PS) 902435/51 (PS) | Domestic (Germany) | 22.30/02.03 (150 °C) |
| | 902435/10 (PS) 902435/11 (PS) | Domestic (Germany) as per DIN EN 1434 | 22.70/99.10 (105 °C) |
| | 902435/50 (PS) 902435/51 (PS) | Domestic (Germany) as per DIN EN 1434 | 22.70/02.03 (150 °C) |
| | 902438/50 (PS) | Module B as per MID ¹ | A0445-2112-2007 (150 °C) |
| | Figure: PL  | 90.276-F80 (PL) 902435/30 (PL) | Domestic (Germany) |
| 902438/30 (PL) | | Domestic (Germany) as per DIN EN 1434 | 22.70/00.01 (180 °C) |
| 902465/30 (PL) | | Module B as per MID ¹ | DE-06-MI004-PTB011 (180 °C) |
| | | Domestic (Germany; Cold) | 22.77/09.01 (150 °C) |

¹ MID = Measuring Instruments Directive, European measuring instrument directive 2004/22/EC

JUMO GmbH & Co. KG
Delivery address: Mackenrodtstraße 14,
36039 Fulda, Germany
Postal address: 36035 Fulda, Germany
Phone: +49 661 6003-0
Fax: +49 661 6003-607
E-mail: mail@jumo.net
Internet: www.jumo.net

JUMO Instrument Co. Ltd.
JUMO House
Temple Bank, Riverway
Harlow, Essex CM20 2DY, UK
Phone: +44 1279 635533
Fax: +44 1279 635262
E-mail: sales@jumo.co.uk
Internet: www.jumo.co.uk

JUMO Process Control, Inc.
8 Technology Boulevard
Canastota, NY 13032, USA
Phone: 315-697-5866
1-800-554-JUMO
Fax: 315-697-5867
E-mail: info@jumo.us
Internet: www.jumo.us



Dimensions

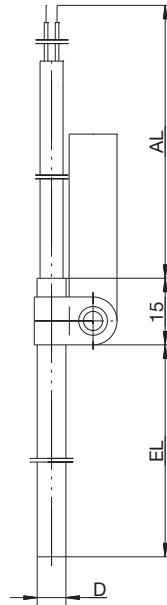
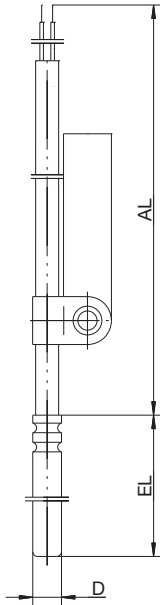

**Basic type 90.276-F40,
902435/05 (PS)
Basic type 902435/10 (PS)
Basic type 902435/50 (PS)
Basic type 902438/50 (PS)**

**Basic type 90.276-F80 (PL)
Basic type 902435/30 (PL)
Basic type 902438/30 (PL)
Basic type 902465/30 (PL)**

JUMO GmbH & Co. KG
 Delivery address: Mackenrodtstraße 14,
 36039 Fulda, Germany
 Postal address: 36035 Fulda, Germany
 Phone: +49 661 6003-0
 Fax: +49 661 6003-607
 E-mail: mail@jumo.net
 Internet: www.jumo.net

JUMO Instrument Co. Ltd.
 JUMO House
 Temple Bank, Riverway
 Harlow, Essex CM20 2DY, UK
 Phone: +44 1279 635533
 Fax: +44 1279 635262
 E-mail: sales@jumo.co.uk
 Internet: www.jumo.co.uk

JUMO Process Control, Inc.
 8 Technology Boulevard
 Canastota, NY 13032, USA
 Phone: 315-697-5866
 1-800-554-JUMO
 Fax: 315-697-5867
 E-mail: info@jumo.us
 Internet: www.jumo.us



Order details: Heat meter RTD temperature probe with connection cable,
 PTB approved 22.30/89.07 (.08; .09), 22.30/99.10, 22.70/99.10, 22.30/02.03, 22.70/02.03

(1) Basic type

| | |
|--|--|
| 902435/10 | Push-in RTD temperature probe (PS) $T_{max.} = 105\text{ °C}$, Thermowell made of stainless steel, for installation in a thermowell |
| 902435/05 (90.276-F40) 902435/50 | Push-in RTD temperature probe (PS) $T_{max.} = 150\text{ °C}$, Thermowell made of stainless steel, for installation in a thermowell |

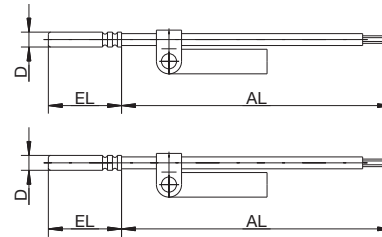

(2) Operating temperature in °C

| | | |
|-----|-----|---|
| x x | 815 | 0 to 105 °C/PVC 105, PUR (only in 2-wire circuit) |
| x | 824 | 0 to 150 °C/Silicone |

(3) Measuring insert

| | | |
|-----|------|-----------------------------|
| x x | 1003 | 1x Pt100 in 2-wire circuit |
| x x | 1004 | 1x Pt500 in 2-wire circuit |
| x x | 1005 | 1x Pt1000 in 2-wire circuit |
| x | 1011 | 1x Pt100 in 4-wire circuit |
| x | 1012 | 1x Pt500 in 4-wire circuit |
| x | 1013 | 1x Pt1000 in 4-wire circuit |

(4) Tolerance class as per DIN EN 60751

| | | |
|-----|---|----------------------|
| x x | 1 | Class B (standard) |
| x | 2 | Class A |
| x | 3 | Class AA (1/3 DIN B) |

(5) Thermowell diameter D in mm

| | | |
|-----|-----|----------|
| x x | 5 | Ø 5 mm |
| x x | 5.2 | Ø 5.2 mm |
| x x | 6 | Ø 6 mm |

(6) Fitting length EL in mm (45 to 85 mm)

| | | |
|-----|-----|--------------------------------------|
| x x | 45 | 45 mm (only for Ø 5 mm and Ø 5.2 mm) |
| x x | 50 | 50 mm (only for Ø 6 mm) |
| x x | 60 | 60 mm (only for Ø 6 mm) |
| x x | ... | Specifications in plain text |

(7) Cable termination

| | | |
|-----|----|---|
| x x | 04 | Tin-plated wires (only for permanently connected temperature probes on the arithmetic unit) |
| x x | 11 | Ferrules as per DIN 46228 Part 4 (standard) |

(8) Connection cable length AL in mm (> 500 mm)

| | | |
|-----|------|---|
| x x | 1500 | 1500 mm |
| x x | 2500 | 2500 mm (Standard) |
| x x | ... | Specifications in plain text (500 mm steps) |

(9) Extra codes

| | | |
|-----|-----|---|
| x x | 000 | None |
| x x | 317 | Shielded connection cable |
| x x | 340 | Version paired as per DIN EN 1434 ² |
| x x | 341 | Version paired as per DIN EN 1434 and calibrated ³ |

Order code (1) (2) (3) (4) (5) (6) (7) (8) (9) ...¹
Order example 902435/10 - 815 - 1003 - 1 - 5 - 45 - 11 - 2500 / 341

Note:
 For the thermowell, refer to the data and price sheet 902440

¹ List extra codes in sequence, separated by commas.
² Price for pairing depends on the quantity; minimum quantity for paired temperature probes: 30 pairs for versions not in stock.
³ Calibration fees as per Federal Law Gazette No. 28 dd. 1.8.2001, quantity-dependent, not subject to discounts

JUMO GmbH & Co. KG
 Delivery address: Mackenrodtstraße 14,
 36039 Fulda, Germany
 Postal address: 36035 Fulda, Germany
 Phone: +49 661 6003-0
 Fax: +49 661 6003-607
 E-mail: mail@jumo.net
 Internet: www.jumo.net

JUMO Instrument Co. Ltd.
 JUMO House
 Temple Bank, Riverway
 Harlow, Essex CM20 2DY, UK
 Phone: +44 1279 635533
 Fax: +44 1279 635262
 E-mail: sales@jumo.co.uk
 Internet: www.jumo.co.uk

JUMO Process Control, Inc.
 8 Technology Boulevard
 Canastota, NY 13032, USA
 Phone: 315-697-5866
 1-800-554-JUMO
 Fax: 315-697-5867
 E-mail: info@jumo.us
 Internet: www.jumo.us



**Order details: Heat meter RTD temperature probe with connection cable,
 PTB approved 22.30/91.05, 22.70/00.01**

(1) Basic type

902435/30 Push-in RTD temperature probe
 for installation in a thermowell (PL),
 Thermowell made stainless steel

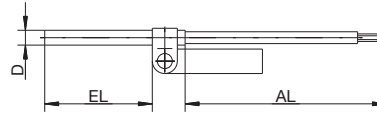

(2) Operating temperature in °C

- x 815 0 to 105 °C/PVC 105 (only in 2-wire circuit)
- x 824 0 to 150 °C/Silicone
- x 830 0 to 180 °C/Silicone

(3) Measuring insert

- x 1003 1x Pt100 in 2-wire circuit
- x 1004 1x Pt500 in 2-wire circuit
- x 1005 1x Pt1000 in 2-wire circuit
- x 1011 1x Pt100 in 4-wire circuit
- x 1012 1x Pt500 in 4-wire circuit
- x 1013 1x Pt1000 in 4-wire circuit

(4) Tolerance class as per DIN EN 60751

- x 1 Class B (standard)
- x 2 Class A
- x 3 Class AA (1/3 DIN B)

(5) Thermowell diameter D in mm

- x 6 Ø 6 mm

(6) Fitting length EL in mm (85 to 400 mm)

- x 105 105 mm
- x 140 140 mm
- x 230 230 mm
- x ... Specifications in plain text

(7) Connection cable termination

- x 04 Tin-plated wires (only for permanently connected temperature probes on the arithmetic unit)
- x 11 Ferrules as per DIN 46228 Part 4 (standard)

(8) Connection cable length AL in mm (> 500 mm)

- x 1500 1500 mm
- x 2500 2500 mm (Standard)
- x ... Specifications in plain text (500 mm steps, max. connection cable length, see table)

(9) Extra codes

- x 000 None
- x 317 Shielded connection cable
- x 340 Version paired as per DIN EN 1434²
- x 341 Version paired as per DIN EN 1434 and calibrated^{2, 3}

Order code (1) (2) (3) (4) (5) (6) (7) (8) (9) ...¹
Order example 902435/30 - 830 - 1003 - 1 - 6 - 140 - 11 - 2500 / 341

Note:
 For the thermowell, refer to the data and price sheet 902440

¹ List extra codes in sequence, separated by commas.
² Price for pairing depends on the quantity; minimum quantity for paired temperature probes: 30 pairs for versions not in stock.
³ Calibration fees as per Federal Law Gazette No. 28 dd. 1.8.2001, quantity-dependent, not subject to discounts

JUMO GmbH & Co. KG
 Delivery address: Mackenrodtstraße 14,
 36039 Fulda, Germany
 Postal address: 36035 Fulda, Germany
 Phone: +49 661 6003-0
 Fax: +49 661 6003-607
 E-mail: mail@jumo.net
 Internet: www.jumo.net

JUMO Instrument Co. Ltd.
 JUMO House
 Temple Bank, Riverway
 Harlow, Essex CM20 2DY, UK
 Phone: +44 1279 635533
 Fax: +44 1279 635262
 E-mail: sales@jumo.co.uk
 Internet: www.jumo.co.uk

JUMO Process Control, Inc.
 8 Technology Boulevard
 Canastota, NY 13032, USA
 Phone: 315-697-5866
 1-800-554-JUMO
 Fax: 315-697-5867
 E-mail: info@jumo.us
 Internet: www.jumo.us



Order details: Heat meter RTD temperature probe with connection cable, MID approved A0445/2112/2007

(1) Basic type

| | |
|---|---|
| 902438/50 | Push-in RTD temperature probe (PS) Thermowell made of stainless steel, for installation in a thermowell |
| (2) Operating temperature in °C | |
| x 815 | 0 to 105 °C/PVC 105, PUR (only in 2-wire circuit) |
| x 824 | 0 to 150 °C/Silicone |
| (3) Measuring insert | |
| x 1003 | 1x Pt 100 in 2-wire circuit |
| x 1004 | 1x Pt 500 in 2-wire circuit |
| x 1005 | 1x Pt1000 in 2-wire circuit |
| x 1011 | 1x Pt100 in 4-wire circuit |
| x 1012 | 1x Pt500 in 4-wire circuit |
| x 1013 | 1x Pt1000 in 4-wire circuit |
| (4) Tolerance class as per DIN EN 60751 | |
| x 1 | Class B (standard) |
| (5) Thermowell diameter D in mm | |
| x 5 | Ø 5 mm |
| x 5.2 | Ø 5.2 mm |
| x 6 | Ø 6 mm |
| (6) Fitting length EL in mm (45 to 85 mm) | |
| x 45 | 45 mm (only for Ø 5 mm and Ø 5.2 mm) |
| x 50 | 50 mm (only for Ø 6 mm) |
| x 60 | 60 mm (only for Ø 6 mm) |
| x ... | Specifications in plain text |
| (7) Connection cable termination | |
| x 04 | Tin-plated wires (only for permanently connected temperature probes on the arithmetic unit) |
| x 11 | Ferrules as per DIN 46228 Part 4 (standard) |
| (8) Connection cable length AL in mm (> 500 mm) | |
| x 1500 | 1500 mm |
| x 2500 | 2500 mm (Standard) |
| x ... | Specifications in plain text (500 mm steps, max. connection cable length, see table) |
| (9) Extra codes | |
| x 000 | None |
| x 317 | Shielded connection cable |
| x 340 | Version paired as per DIN EN 1434 ² |
| x 761 | Version paired as per DIN EN 1434 and CE and metrology sign (first calibration) ² |

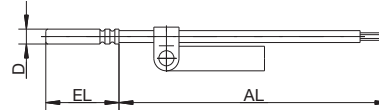

| | | | | | | | | | | | | | | | | | |
|----------------------|-----------|-----|-----|-----|------|-----|-----|-----|-----|-----|--------------|---|----|---|------|---|-----|
| Order code | (1) | (2) | (3) | (4) | (5) | (6) | (7) | (8) | (9) | ... | ¹ | | | | | | |
| Order example | 902438/50 | - | 824 | - | 1003 | - | 1 | - | 5 | - | 45 | - | 11 | - | 2500 | / | 761 |

Note:
 For the thermowell, refer to the data and price sheet 902440

¹ List extra codes in sequence, separated by commas.
² Price for pairing depends on the quantity; minimum quantity for paired temperature probes: 30 pairs for versions not in stock.

JUMO GmbH & Co. KG
 Delivery address: Mackenrodtstraße 14,
 36039 Fulda, Germany
 Postal address: 36035 Fulda, Germany
 Phone: +49 661 6003-0
 Fax: +49 661 6003-607
 E-mail: mail@jumo.net
 Internet: www.jumo.net

JUMO Instrument Co. Ltd.
 JUMO House
 Temple Bank, Riverway
 Harlow, Essex CM20 2DY, UK
 Phone: +44 1279 635533
 Fax: +44 1279 635262
 E-mail: sales@jumo.co.uk
 Internet: www.jumo.co.uk

JUMO Process Control, Inc.
 8 Technology Boulevard
 Canastota, NY 13032, USA
 Phone: 315-697-5866
 1-800-554-JUMO
 Fax: 315-697-5867
 E-mail: info@jumo.us
 Internet: www.jumo.us



**Order details: Heat meter RTD temperature probe with connection cable,
 MID approved DE-06-MI004-PTB011**

(1) Basic type

902438/30 Push-in RTD temperature probe
 for installation in a thermowell (PL),
 Thermowell made stainless steel

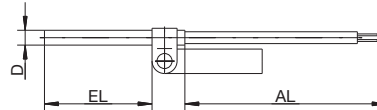

(2) Operating temperature in °C

- x 815 0 to 105 °C/PVC 105, PUR (only in 2-wire circuit)
- x 824 0 to 150 °C/Silicone
- x 830 0 to 180 °C/Silicone

(3) Measuring insert

- x 1003 1x Pt100 in 2-wire circuit
- x 1004 1x Pt500 in 2-wire circuit
- x 1005 1x Pt1000 in 2-wire circuit
- x 1011 1x Pt100 in 4-wire circuit
- x 1012 1x Pt500 in 4-wire circuit
- x 1013 1x Pt1000 in 4-wire circuit

(4) Tolerance class as per DIN EN 60751

- x 1 Class B (standard)
- x 2 Class A
- x 3 Class AA (1/3 DIN B)

(5) Thermowell diameter D in mm

- x 6 Ø 6 mm

(6) Fitting length EL in mm (105 to 450 mm)

- x 105 105 mm
- x 140 140 mm
- x 230 230 mm
- x ... Specifications in plain text

(7) Connection cable termination

- x 04 Tin-plated wires (only for permanently connected temperature probes on the arithmetic unit)
- x 11 Ferrules as per DIN 46228 Part 4 (standard)

(8) Connection cable length AL in mm (> 500 mm)

- x 1500 1500 mm
- x 2500 2500 mm (Standard)
- x ... Specifications in plain text (500 mm steps, max. connection cable length, see table)

(9) Extra codes

- x 000 None
- x 317 Shielded connection cable
- x 340 Version paired as per DIN EN 1434²
- x 761 Version paired with CE and metrology sign (first calibration)²

Order code (1) (2) (3) (4) (5) (6) (7) (8) (9) ...¹
Order example 902438/30 - 830 - 1003 - 1 - 6 - 140 - 11 - 2500 / 761

Note:
 For the thermowell, refer to the data and price sheet 902440

¹ List extra codes in sequence, separated by commas.
² Price for pairing depends on the quantity; minimum quantity for paired temperature probes: 30 pairs for versions not in stock.

JUMO GmbH & Co. KG
 Delivery address: Mackenrodtstraße 14,
 36039 Fulda, Germany
 Postal address: 36035 Fulda, Germany
 Phone: +49 661 6003-0
 Fax: +49 661 6003-607
 E-mail: mail@jumo.net
 Internet: www.jumo.net

JUMO Instrument Co. Ltd.
 JUMO House
 Temple Bank, Riverway
 Harlow, Essex CM20 2DY, UK
 Phone: +44 1279 635533
 Fax: +44 1279 635262
 E-mail: sales@jumo.co.uk
 Internet: www.jumo.co.uk

JUMO Process Control, Inc.
 8 Technology Boulevard
 Canastota, NY 13032, USA
 Phone: 315-697-5866
 1-800-554-JUMO
 Fax: 315-697-5867
 E-mail: info@jumo.us
 Internet: www.jumo.us



Order details: Cold / combined cold/heat meter RTD temperature probes with connection cable,
 MID approved DE-06-MI004-PTB011, PTB approved 22.77/09.01

(1) Basic type

| | |
|-----------|--|
| 902465/30 | Push-in RTD temperature probe for installation in a thermowell (PL), Thermowell made stainless steel |
|-----------|--|

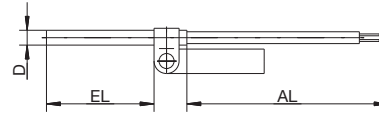

| | |
|---|--|
| | (2) Operating temperature in °C |
| x | 824 0 to 150 °C/Silicone |
| | (3) Measuring insert |
| x | 1003 1x Pt100 in 2-wire circuit |
| x | 1004 1x Pt500 in 2-wire circuit |
| x | 1005 1x Pt1000 in 2-wire circuit |
| x | 1011 1x Pt100 in 4-wire circuit |
| x | 1012 1x Pt500 in 4-wire circuit |
| x | 1013 1x Pt1000 in 4-wire circuit |
| | (4) Tolerance class as per DIN EN 60751 |
| x | 1 Class B (standard) |
| x | 2 Class A |
| x | 3 Class AA (1/3 DIN B) |
| | (5) Thermowell diameter D in mm |
| x | 6 Ø 6 mm |
| | (6) Fitting length EL in mm (105 to 450 mm) |
| x | 105 105 mm |
| x | 140 140 mm |
| x | 230 230 mm |
| x | ... Specifications in plain text |
| | (7) Connection cable termination |
| x | 04 Tin-plated wires (only for permanently connected temperature probes on the arithmetic unit) |
| x | 11 Ferrules as per DIN 46228 Part 4 (standard) |
| | (8) Connection cable length AL in mm (> 500 mm) |
| x | 1500 1500 mm |
| x | 2500 2500 mm (Standard) |
| x | ... Specifications in plain text (500 mm steps, max. connection cable length, see table) |
| | (9) Extra codes |
| x | 000 None |
| x | 317 Shielded connection cable |
| x | 340 Version paired as per DIN EN 1434 ² |
| x | 341 Version paired as per DIN EN 1434 and calibrated (cold, only for Germany) ^{2, 3} |
| x | 761 Version paired with CE and metrology sign (first calibration, heat) ² |

| | | | | | | | | | | | | | | | | | |
|----------------------|-----------|-----|-----|-----|------|-----|-----|-----|-----|-----|--------------|---|----|---|------|---|---------|
| Order code | (1) | (2) | (3) | (4) | (5) | (6) | (7) | (8) | (9) | ... | ¹ | | | | | | |
| Order example | 902465/30 | - | 824 | - | 1003 | - | 1 | - | 6 | - | 140 | - | 11 | - | 2500 | / | 341.761 |

Note:
 For the thermowell, refer to the data and price sheet 902440

¹ List extra codes in sequence, separated by commas.
² Price for pairing depends on the quantity; minimum quantity for paired temperature probes: 30 pairs for versions not in stock.
³ Calibration fees as per Federal Law Gazette No. 28 dd. 1.8.2001, quantity-dependent, not subject to discounts